

# BS&k Company

MANUFACTURERS REPRESENTATIVE

## IN MOTION FOR YOU ...

### Spring 2009

Volume 11, Issue 2



### LUMSDEN'S EDGEWISE BELT HAS DRASTICALLY REDUCED BELT WASTE DUE TO TANGLING

Lumsden's Edgewise edge has proven to many customers that this design prevents tangling and catching of the wires both on and off the machine. They come off the rolls un-tangled, they don't catch on adjoining belts, and there are no ends to bend open and break.

Less downtime, less scrap and with the buffed edge, less cut hands.

With the edgewise edge, wires do not have to be opened and then closed again to splice belt. This prevents the ends from breaking off, and having to re-splice the belt, like other belts do.



Edgewise edges are available on all belts in the 3/8", 1/2" and 5/8" pitches. The part numbers get a "6" in front of them, but everything else stays the same. The edges are buffed to remove any burrs which in the past have caused cuts on some hands and an unpleasant experience. That has improved and so has the life of the belts all because of the Edgewise edge.

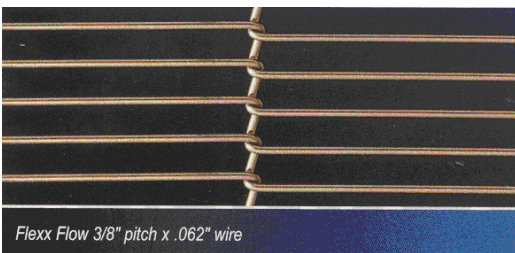

Flexx Flow 3/8" pitch x .062" wire

#### Inside this issue:

Wrabacon flips your lids on exactly	2
POBCO adds more new products	2
REMCO Color code the plant for safety	3
SATECH Anti-Fatigue Mats	3
Belt Technologies has solid belting	3
Lumsden's drive components save you \$	4
MeltPro if you glue it, we can do it.	4
Wiremation has the right track for you.	5
BS&k Let us do the work for you	5

#### Special points of interest:

- **Wrabacon** updates its website
- **Lumsden** solves the dreaded problems of "belt snagging".
- **Wiremation** introduces standard sprocket driven mesh belts
- **SATECH** has the next generation of anti-fatigue mats to support your workforce.
- **REMCO** Color code your plant to reduce your sanitation problems
- **POBCO Plastics** adds to its PET wear strip line up



# WE PROVIDE SOLUTIONS TO YOUR AUTOMATION CHALLENGES

## Lidding Equipment

### Rotary, In Line Lidding Equipment Designs

Wrabacon Inc. manufactures **rotary or in line lidding equipment** designs. Lids are denested from a stack and individually transported to the capping head. The lids are then automatically capped. Designs range from 8 oz. to 60 gallon capacity containers. Stainless steel *lidders are available* for food and pharmaceutical applications.

### Lidding Equipment Features and Benefits

- Automatically denests lids, places them on filled containers and seals them.
- Stainless steel or mild steel available



## REDUCE FRICTION, REDUCE DOWNTIME, IMPROVE PRODUCTION AND REDUCE HEADACHES—POBCO PLASTICS

Pobco has our newest catalog available to you. It contains 128 pages of conveyor components such as Lube Filled Chain guides, Slit Flange Bearings, Roller Chain Guides, with #50 K-1 attachments, Low Friction UHMW Neck Guides, Accumulator Conveyor Tubing, one and two piece Spools, Medium Duty Sanitary Mounts, Pillow Blocks, 2 bolt Side Flange, 3 bolt Flanges and 4 bolt Side Flanges, plus a whole lot more.

We like to call it our wish book, because 1/2 of what we make in not even in there. We can't list everything so give us a call, send us a sketch or print or ask us to visit you to see the application.

**POBCO Wood & Plastic Bearings**

**Our Product Lines Include:**

- > Wood Bearings
- > Plastic Bearings
- > Guide Rails
- > Chain Guides
- > Wear Strip
- > Custom Profiles & Parts
- > Rollers
- > Pulleys
- > Sprockets
- > Chain Tensioners
- > Bases
- > Custom Products

POBCO can cross reference parts from: McMaster, Grainger, MSC, Martin, Boston Gear and Other Suppliers

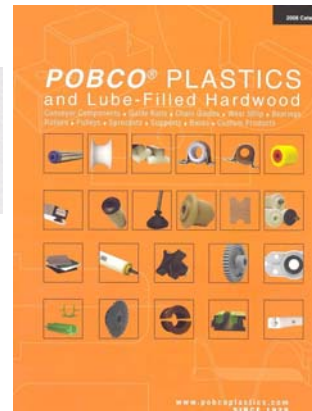
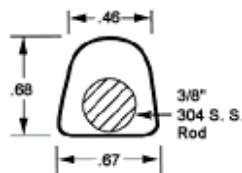
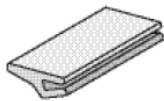

Ask for your **FREE** copy today!



REMCO KEEPS YOUR WORKPLACE CLEAN AND SANITARY

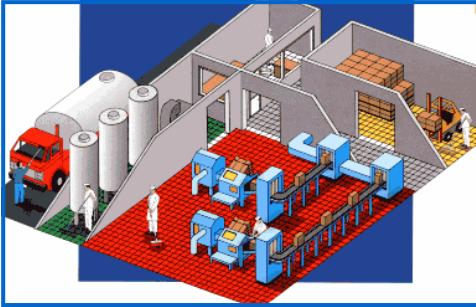

Products from REMCO can be color-coded to help divide the production cycle into different zones or tasks. By identifying these as different cleaning areas, the movement of contaminants around the production area can be effectively blocked.

Let BS&k show you how REMCO products can clean up your sanitation problems and let you get back to what you do best, that is, running your business.



ANTI-FATIGUE TECHNOLOGY TO REDUCE INJURIES AND FATIGUE AND INCREASE PRODUCTIVITY

SATECH offers the marketplace a new generation of cushioning technology for workplace, healthcare, athletic and equestrian applications to reduce fatigue and injury and improve productivity. Standing workers

SmartCells® mats feature solid rubber edges

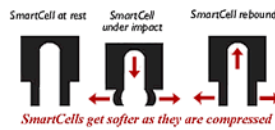

SmartCells get softer as they are compressed

fatigue mats, runners and platforms. Elderly and frail individuals are provided fall protection from SmartCells shock-attenuating surfaces. Athletes train more

experience less back, leg and foot pain, from Smart-Cells anti-

efficiently with less injuries due to Smart-Cells ability to absorb, cushion and redirect impact energy.



METAL BELTS THAT DRIVE PRODUCTIVITY: CONVEYOR BELTS, INDEX BELTS, SPECIALTY BELTS AND THE CONVEYORS



Conveyor belts manufactured by Belt Technologies, Inc. are engineered using stainless steel and welded endless, using a high energy beam technique. The welded area is extremely strong and is weld finished to give a smooth surface. Other metals can be used for increased strength, heat resistance and flatness. Belts are manufactured in widths from .080" to a current maximum of 36" and can be coated with Teflon®, polyurethane and rubber. Belt thicknesses range from .001" to .031" and are designed to meet the customer's application requirements. Plain belts are friction tracked or a PVC, Neoprene or Silicon Rubber V-belt can be bonded to the belt for force tracking.



PROPER DRIVING AND PROTECTING OF FLEXX FLOW BELTS ARE THE KEYS TO GETTING LONG LIFE



**Don't forget your drive components!**

We can supply the sprockets, idle rollers, nose rollers as well as the wear strips and belt supports.

Your sprockets are by far the most important factor for a long, smooth running conveyor. Besides having the correct pitch, the teeth need to be tall enough to prevent slippage of the belt and low enough to allow the release of the belt. The wrong sprocket will wear the belt wires prematurely. Let us take a look at your application to assure you have proper sprockets.



And don't forget about what your belt rides on. Friction is a big reason your belt will fail. Friction means something is wearing on something else. And, something has to give. Don't let it be the belt for the cost of some inexpensive plastic. We have the wear strips and products to prevent this.



The nose rollers, in addition to tracking the belt, protect the fragile "Z" bends of the belt. By keeping the nose rollers fresh you prevent wearing out the "Z" bends and your belt. By replacing the nose rollers, with the correct size, before they wear down, you can increase the life of the belt and extend maintenance intervals. Let us show you how we can save you money.



IF YOU GLUE IT, WE CAN DO IT!

**MeltPro** manufactures a complete product line of hot melt adhesive dispensing equipment and has been servicing the industry since 1987 with great success. Many features have been incorporated into our product line that makes us the leader in hot melt products/components to fit Nordson®, Itw/Lti®, Slautterback® and other O.E.M. systems.

**MeltPro** is the only aftermarket supplier to be selected as a member of the PMMI organization (**Packaging Machinery Manufacturers Institute**). **MeltPro** was selected due to its high standards of manufacturing products, quality control procedures, engineered drawings, manufacturing facility and procedures to insure product reliability.



Let us provide a sample for you to test and see what we can do for you, and your application.



## WIREMATION "GIVES TEETH" TO SPROCKET DRIVEN MESH BELTS WITH TRAXX-RITE

Wiremation's line of sprocket driven mesh belts, **Traxx Rite**, stops edge damage by positive tracking of the belts. By incorporating a precision made Balanced Weave Belt with a corresponding sprocket, positive tracking, both laterally and longitudinally can be achieved.

This belt is commonly used in the food industry where a tight transfer or exact timing is needed. The sprocket eliminates belt slippage when the product or process creates slippery conditions. The teeth of the sprocket meshes into the openings of the belt to create a

positive drive. This system is less expensive to purchase, and less expensive to operate than heavy chain edge belts.

Don't be fooled by others that tell you it can't be done or they are the only company that can make this happen. Wiremation has been doing this for years and has many satisfied customers. Now, with an extensive line of meshes and sprocket combinations, we can tackle your problems

Ask to see our standard product line of meshes and sprockets. Let's discuss your application and see if we can eliminate at least one of your daily headaches.

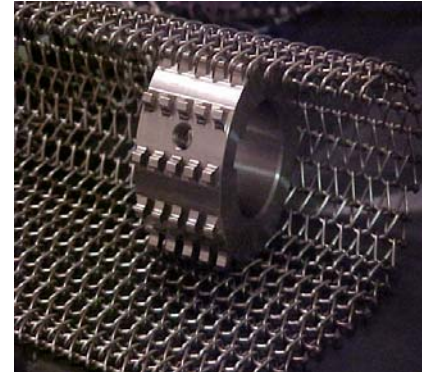

Let us show you what we can do!

Here are some of our standard meshes.

TR 18-16-16,	TR30-24-17,
TR30-31-16,	TR42-36-18,
TR48-52-17,	TR60-48-18/20



## BS&k COMPANY INTEGRATES LOCAL SERVICE WITH NATIONAL KNOWLEDGE

The BS&k company has been providing local service to companies for 11 years.

Knowledge we have gained from working with national companies has allowed us to service companies locally, the way most national companies get serviced.

With 34 years experience in sales and manufacturing environments, we know how critical it is to you to have your lines up and running, when you need them up and running. We won't let you down!

Let us work with you and provide the following:

- *Plant Surveys*
- *Complimentary Product lines*
- *Competitive Pricing*
- *On-site troubleshooting*
- *Installation Assistance*
- *Order History Analysis*
- *Stocking Plans*

Contact us today and let us show you what we can do for you.

Don't forget to ask us for your No cost / no obligation review of your production lines.

We have a CD with our literature, catalogs and other information on it. Let us send one to you.

(800) 634-1114 (Toll free)  
 (704) 365-6408 (Local)  
 (704) 365-3578 (Fax)

[www.bsandk.com](http://www.bsandk.com)

[bob@bsandk.com](mailto:bob@bsandk.com)



[sue@bsandk.com](mailto:sue@bsandk.com)



2248 Lawton Bluff Road  
Charlotte, NC 28226



*In motion for you . . .*



Robert A. Williams



Sue Williams



Lumsden Flexx Flow

Wiremation Woven Wire

Metal Conveyor Belts



Pobco Plastic and lube filled Hardwood  
Conveyor Components

Wood Bearings



Innovative Equipment  
for Product Handling

[www.bsandk.com](http://www.bsandk.com)

Remco Sanitation Items



Conveyors, Fabricators



Quantik Industrial  
Corporation—Induction

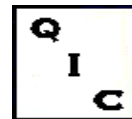

SATECH  
Anti-Fatigue Matting



Belt Technologies



CONVEYORS - CONVEYOR BELTS - CONVEYOR COMPONENTS

2248 Lawton Bluff Road, Charlotte, NC 28226 (800) 634-1114[Phone] (704) 365-3578[Fax]  
www.bsandk.com email bob@bsandk.com