

BS&k Company

MANUFACTURERS REPRESENTATIVE

IN MOTION FOR YOU ...

Winter 2009

Volume 11, Issue 1



WIRESATION HAS THE FLAT WIRE BELT AND SPROCKET LINE UP — THE ECONOMICAL CHOICE FOR GENERAL CONVEYING

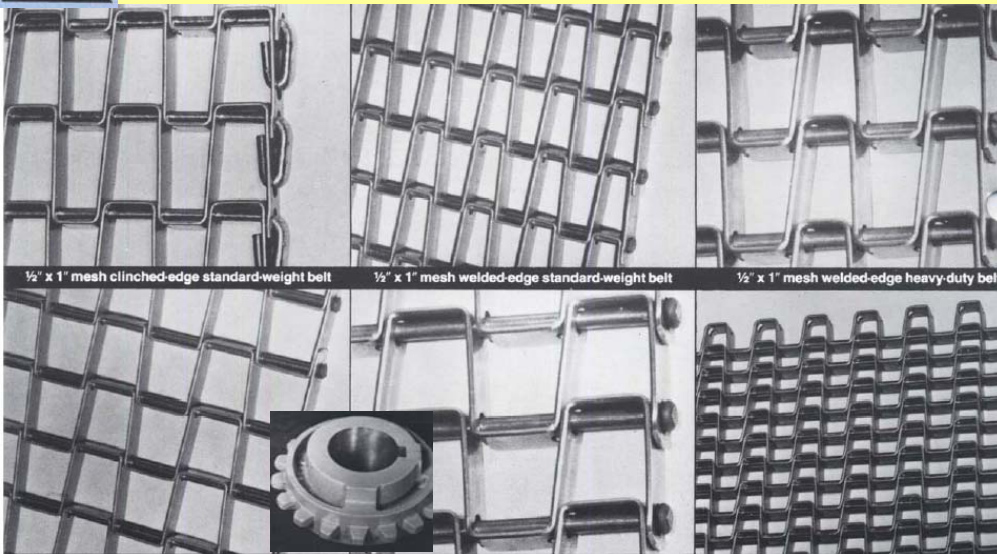

Inside this issue:

Wrabacon Automation and Conveyors	2
POBCO Reduces Your Friction	2
REMCO Sanitation Products	3
SATECH Anti-Fatigue Mats	3
Belt Technologies has solid belts	3
Lumsden's Edgewise stops tangles	4
MeltPro if you glue it, we can do it.	4
Wiremation on the right track	5
BS&k Can work for you	5

Flat Wire belts from Wiremation offer important advantages in many industrial applications and food processing applications. They provide faster drainage of liquids, free air circulation and ease of cleaning. Thus, they are ideal in operations where sanitation is a prime consideration. The flat surface also facilitates transfer operations such as sorting or assembling.

Wiremation flat wire belting is available in mesh sizes 1/2 X 1/2, 1/2 X 1 and 1 X 1. Materials available are galvanized, carbon steel and 304 and 316 stainless steel. Its strength, durable construction and dependable performance can meet and exceed your most demanding on the job requirements.

- **Special points of interest:**
- **Wrabacon** updates its website
- **Lumsden** solves the dreaded problems of "belt snagging".
- **Wiremation** Introduces standard sprocket driven mesh belts
- **SATECH** has the next generation of anti-fatigue mats to support your workforce.
- **REMCO** Color code your plant to reduce your sanitation problems
- **POBCO Plastics** adds to it's PET wear strip line up



WE PROVIDE SOLUTIONS TO YOUR AUTOMATION CHALLENGES

Straight Incline / Z Style Inclines

Wrabacon's incline conveyors are designed to move product between two different elevations.



They can be used to convey between a mezzanine to floor level docks, overhead conveyor to floor applications, and other jobs where product must be conveyed at an angle. Incline Conveyors are designed to run at fixed or variable speeds to fit in with existing applications a customer may be using. Our conveyors will operate independently, or can be integrated with other equipment. Our incline conveyors permit the transfer of bulk materials at inclines from 18° to 90° angles.



Incline Conveyor Features and Benefits

- Move products from one elevation to another
- Straight and Z style configurations available
- Available in cleated belts or rough top
- Painted steel or Stainless steel construction
- Incline conveyors available in variable and fixed speeds



REDUCE FRICTION, REDUCE DOWNTIME, IMPROVE PRODUCTION AND REDUCE HEADACHES—POBCO PLASTICS

Pobco has our newest catalog available to you. It contains 128 pages of conveyor components such as Lube Filled Chain guides, Slit Flange Bearings, Roller Chain Guides, with #50 K-1 attachments, Low Friction UHMW Neck Guides, Accumulator Conveyor Tubing, one and two piece Spools, Medium Duty Sanitary Mounts, Pillow Blocks, 2 bolt Side Flange, 3 bolt Flanges and 4 bolt Side Flanges, plus a whole lot more.

We like to call it our wish book, because 1/2 of what we make in not even in there. We can't list everything so give us a call, send us a sketch or print or ask us to visit you to see the application.

POBCO Wood & Plastic Bearings



- Our Product Lines Include:**
- > Wood Bearings
 - > Plastic Bearings
 - > Guide Rails
 - > Chain Guides
 - > Wear Strip
 - > Custom Profiles & Parts
 - > Rollers
 - > Pulleys
 - > Sprockets
 - > Chain Tensioners
 - > Bases
 - > Custom Products

POBCO can cross reference parts from: McMaster, Grainger, MSC, Martin, Boston Gear and Other Suppliers

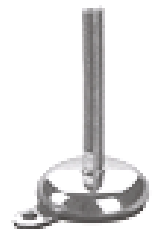
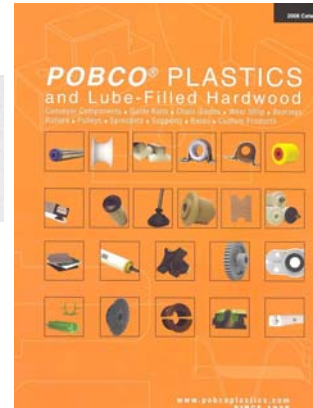
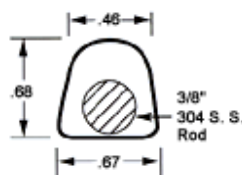
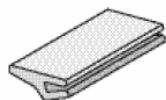

Ask for your FREE copy today!

REMCO PRODUCTS

REMCO KEEPS YOUR WORKPLACE CLEAN AND SANITARY

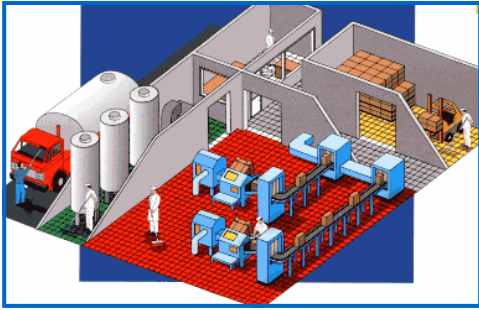

Products from Remco can be color-coded to help divide the production cycle into different zones or tasks. By identifying these as different cleaning areas, the movement of contaminants around the production area can be effectively blocked.

Let BS&k show you how REMCO products can clean up your sanitation problems and let you get back to what you do best, that is, running your business.



SATECH SEAMLESS ATTENUATING TECHNOLOGIES

ANTI-FATIGUE TECHNOLOGY TO REDUCE INJURIES AND FATIGUE AND INCREASE PRODUCTIVITY

SATECH offers the marketplace a new generation of cushioning technology for workplace, healthcare, athletic and equestrian applications to reduce fatigue and injury and improve productivity. Standing workers

SmartCells® mats feature solid rubber edges

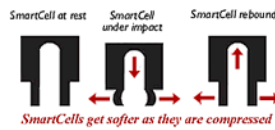

SmartCells get softer as they are compressed

fatigue mats, runners and platforms. Elderly and frail individuals are provided fall protection from SmartCells shock-attenuating surfaces. Athletes train more

experience less back, leg and foot pain, from Smart-Cells anti-

efficiently with less injuries due to Smart-Cells ability to absorb, cushion and redirect impact energy.



METAL BELTS THAT DRIVE PRODUCTIVITY: CONVEYOR BELTS, INDEX BELTS, SPECIALTY BELTS AND THE CONVEYORS



Conveyor belts manufactured by Belt Technologies, Inc. are engineered using stainless steel and welded endless, using a high energy beam technique. The welded area is extremely strong and is weld finished to give a smooth surface. Other metals can be used for increased strength, heat resistance and flatness. Belts are manufactured in widths from .080" to a current maximum of 36" and can be coated with Teflon®, polyurethane and rubber. Belt thicknesses range from .001" to .031" and are designed to meet the customer's application requirements. Plain belts are friction tracked or a PVC, Neoprene or Silicon Rubber V-belt can be bonded to the belt for force tracking.



LUMSDEN'S EDGEWISE BELT HAS DRASTICALLY REDUCED BELT WASTE DUE TO TANGLING



Lumsden's **Edgewise** edge has proven to many customers that this design prevents tangling and catching of the wires both on and off the machine. They come off the rolls un-tangled, they don't catch on adjoining belts, and there are no ends to bend open and break.

Less downtime, less scrap and with the buffed edge, less cut hands. A real winner in all cases.

With the **Edgewise** edge, wires do not have to be opened and then closed again to splice belt. This prevents the ends from breaking off, and having to re-splice the belt, like other belts do.



Don't forget your drive components!

We can supply the sprockets, idle rollers, nose rollers as well as the wear strips and belt supports. The nose rollers, in addition to tracking, protect the "Z" bends of the belt. By replacing them before they wear down, you can increase the life of the belt and extend maintenance intervals. Let us show you how we can save you money.



IF YOU GLUE IT, WE CAN DO IT!

MeltPro manufactures a complete product line of hot melt adhesive dispensing equipment and has been servicing the industry since 1987 with great success. Many features have incorporated into our product line that makes us the leader in hot melt products/components to fit Nordson®, Itw/Lti®, Slautterback® and other O.E.M. systems.

MeltPro is the only aftermarket supplier to be selected as a member of the PMMI organization (**Packaging Machinery Manufacturers Institute**). **MeltPro** was selected due to its high standards of manufacturing products, quality control procedures, engineered drawings, manufacturing facility and procedures to insure product reliability.



Let us provide a sample for you to test and see what we can do for you, and your application.



WIREMATION "GIVES TEETH" TO SPROCKET DRIVEN MESH BELTS WITH TRAXX-RITE

Wiremation's line of sprocket driven mesh belts, **Traxx Rite**, stops edge damage by positive tracking of the belts. By incorporating a precision made Balanced Weave Belt with a corresponding sprocket, positive tracking, both laterally and longitudinally can be achieved.

This belt is commonly used in the food industry where a tight transfer or exact timing is needed. The sprocket eliminates belt slippage when the product or process creates slippery conditions. The teeth of the sprocket meshes into the openings of the belt to create a

positive drive. This system is less expensive to purchase, and less expensive to operate than heavy chain edge belts.

Don't be fooled by others that tell you it can't be done or they are the only company that can make this happen. Wiremation has been doing this for years and has many satisfied customers. Now, with an extensive line of meshes and sprocket combinations, we can tackle your problems

Ask to see our standard product line of meshes and sprockets. Let's discuss your application and see if we can eliminate at least one of your daily headaches.

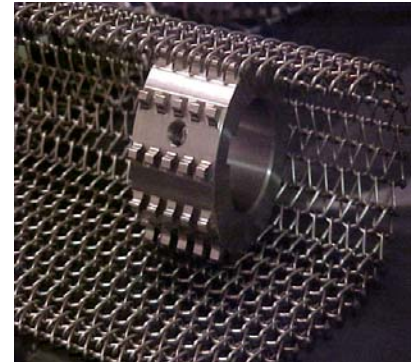

Let us show you what we can do!

Here are some of our standard meshes.

TR 18-16-16,	TR30-24-17,
TR30-31-16,	TR42-36-18,
TR48-52-17,	TR60-48-18/20



BS&k COMPANY INTEGRATES LOCAL SERVICE WITH NATIONAL KNOWLEDGE

The BS&k company has been providing local service to companies for 10 years.

Knowledge we have gained from working with national companies has allowed us to service companies locally, the way most national companies get serviced.

With 30 years experience in sales and manufacturing environments, we know how critical it is to you to have your lines up and running, when you need them up and running. We won't let you down!

Let us work with you and provide the following:

- *Plant Surveys*
- *Complimentary Product lines*
- *Competitive Pricing*
- *On-site troubleshooting*
- *Installation Assistance*
- *Order History Analysis*
- *Stocking Plans*

Contact us today and let us show you what we can do for you.

Don't forget to ask us for your No cost / no obligation review of your production lines.

We have a CD with our literature, catalogs and other information on it. Let us send one to you.

(800) 634-1114 (Toll free)
 (704) 365-6408 (Local)
 (704) 365-3578 (Fax)

www.bsandk.com

bob@bsandk.com



sue@bsandk.com



2248 Lawton Bluff Road
Charlotte, NC 28226



Robert A. Williams



Sue Williams



Lumsden Flexx Flow

Wiremation Woven Wire

Metal Conveyor Belts



Pobco Plastic and lube filled Hardwood
Conveyor Components

Wood Bearings



Innovative Equipment
for Product Handling



Remco Sanitation Items



Conveyors, Fabricators



Quantik Industrial
Corporation—Induction

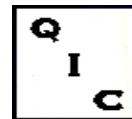

SATECH
Anti-Fatigue Matting



Belt Technologies



CONVEYORS - CONVEYOR BELTS - CONVEYOR COMPONENTS

2248 Lawton Bluff Road, Charlotte, NC 28226 (800) 634-1114[Phone] (704) 365-3578[Fax]
www.bsandk.com email bob@bsandk.com