

**DISCHARGE ROLLER**



Part #	Roller Diameter	Bore	Roller Width	Groove Width	Groove Depth
DR-036363-1	5/8"	3/16"	5/8"	1/4"	3/16"
DR-07563-1	3/4"	3/16"	5/8"	1/4"	3/16"
DR-10075-1	1.00"	1/4"	3/4"	3/8"	1/4"
DR-12575-1	1 1/4"	1/2"	3/4"	3/8"	.230
DR-15010-1	1 1/2"	1/2"	1.00"	1/2"	.230
DR-15075-1	1 1/2"	3/4"	3/4"	3/8"	.230
DR-11851-1	30MM	8MM	13MM	5MM	7M



**END ROLLERS**

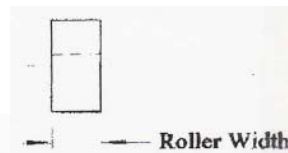

Part #	Roller Diameter	Bore	Roller Width
ER-06363-2	5/8"	3/16"	5/8"
ER-07563-2	3/4"	3/16"	5/8"
ER-11851-2	30MM	8MM	13MM



**FLANGED END ROLLERS**

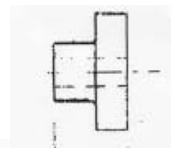

Part #	Roller Diameter	Bore	Roller Width	Hub Diameter	Hub Width
ER-10075-2	1.00"	1/4"	9/16"	1/2"	3/8"
ER-12575-2	1 1/4"	1/2"	9/16"	.790"	3/8"
ER-15010-2	1 1/2"	1/2"	1.00"	1.040"	3/4"
ER-15075-2	1 1/2"	3/4"	3/4"	1.040"	9/16"



**BS&k Company**