

# conveyors

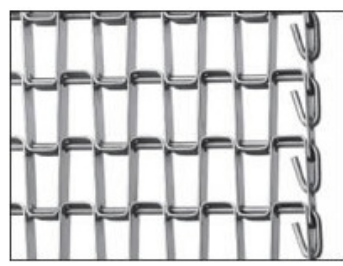

# Conveyor Belts

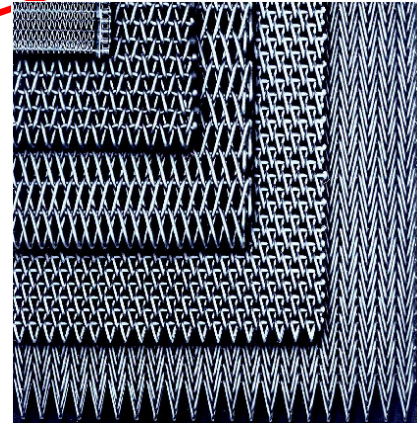
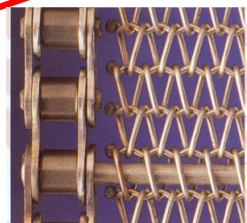
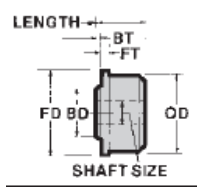
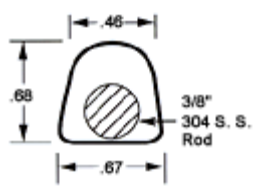
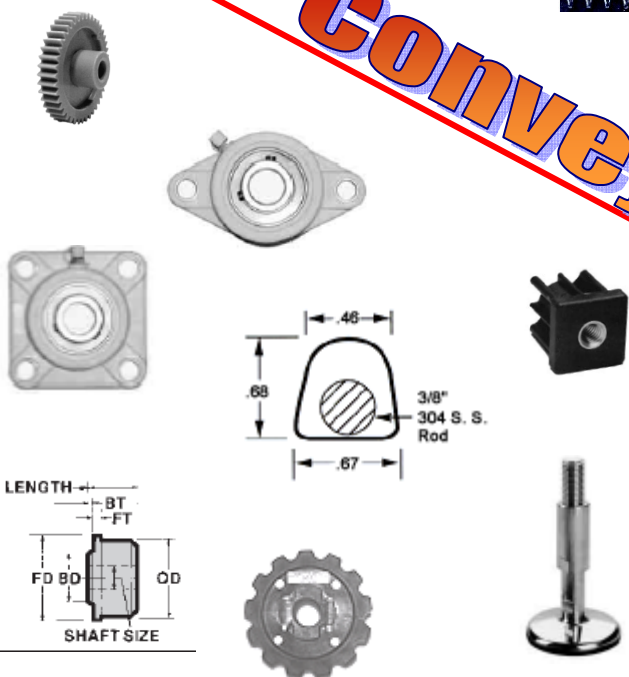
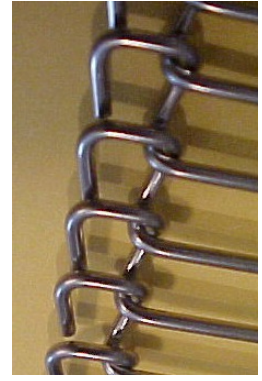
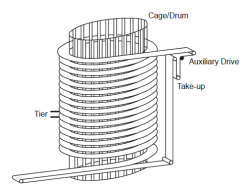

# Conveyor Components



## Conveyors

|  |          |
|--|----------|
| <i>Conroll Inc.</i>                            | <b>3</b> |
| Low and Zero Backpressure ShaftDrive conveyors |          |
| <i>Wrabacon, Inc:</i>                          | <b>4</b> |
| Custom Conveyors and Automation systems        |          |

## Conveyor Belts

|  |           |
|--|-----------|
| <i>Lumsden Flexx Flow:</i>   | <b>5</b>  |
| Single plane metal processing conveyor belts & sprockets                                     |           |
| <i>Wiremation:</i>   | <b>8</b>  |
| Woven Wire Metal Processing Belts, Balanced Weave,<br>Baking Bands, Oven Belts, Fryer Belts. |           |
| Filter Belts   | <b>9</b>  |
| Furnace Curtains   | <b>10</b> |
| <i>Special Belts:</i>  |           |
| Fabric belts and metal spiral belts  | <b>11</b> |

## Conveyor Components

|  |           |
|--|-----------|
| <i>POBCO, Inc.:</i>  | <b>12</b> |
| Anti-Friction Devices, plastic wear strips, roll ends, bearings      |           |
| <i>Lubri-Lab Products:</i>   | <b>14</b> |
| Oil additives and greases for increased life of bearings and engines |           |
| <i>Remco Products:</i>   | <b>15</b> |
| Plastic shovels, scrapers, squeegees and tubs                        |           |

## BS&k

|                            |           |
|----------------------------|-----------|
| <i>Comments:</i>           | <b>16</b> |
| <i>Contact Information</i> | <b>18</b> |



Conroll:

Shaft Drive conveyors

- No exposed belts or guards required
- Safe, low voltage 24 VDC brushless motors
- Perfect for transport and zero pressure accumulation

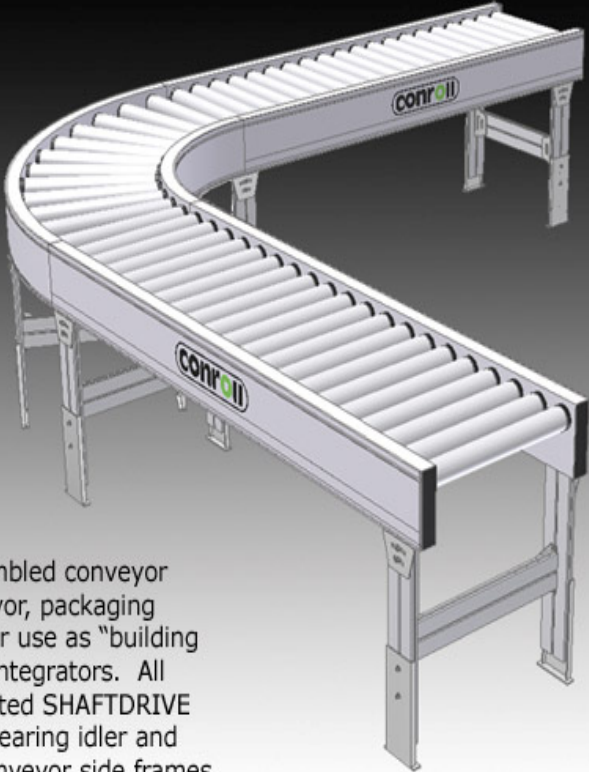

Conroll produces a variety of pre-assembled conveyor modules for use by OEMs in the conveyor, packaging and processing industries, as well as for use as "building blocks" for material handling systems integrators. All of our modules are based on the patented SHAFTDRIVE design, utilizing precision ground ball bearing idler and drive cartridges mounted within the conveyor side frames.

### The ShaftDrive Concept

The ShaftDrive concept advances modern 24VDC conveying systems to the next level. Conveyor rollers normally have "dead" shafts which serve only to support loads.

At Conroll, we have made them "live" so that they serve a dual function; both supporting conveyed loads and providing motive power. Mounted on precision bearings, conveyor stub-shafts can be teamed with a variety of carrying elements - conveyor rollers of almost any material, as well as any desired configuration of conveying wheels.

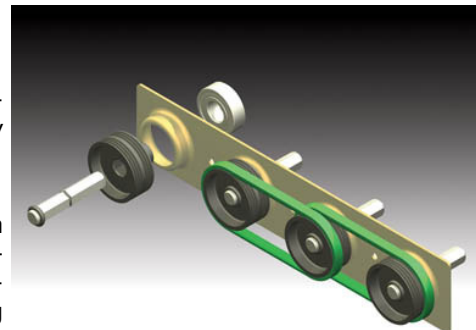

There are no exposed belts, chains or motors in a ShaftDrive system. Consequently, there are no pinch points that mandate space-wasting guards. Operation is extremely quiet with brushless 24VDC motors providing motive power.

CONVEYORS

# CONVEYORS

*Wrabacon Inc.:*



Custom conveying and automation systems

## Automated Conveyors | Industrial Conveyor Systems

Being a company who specializes in creative custom automation, Wrabacon employs a team of mechanical and electrical engineers, as well as programmers. We have backgrounds in a variety of industries including food, pharmaceutical, automotive, sporting goods and other consumer products.



We design and manufacture equipment that will convey, accumulate, merge, divert, pick & place, transfer, orient, stack, denest and lid different types of products. Wrabacon can also provide complete system integration for a project if required.

Our engineering department uses state-of-the-art computers and CAD systems to produce sound engineering designs. We have a complete panel shop with experienced technicians for the most sophisticated project.

As a team, we will provide a simple and cost effective design for your application. No matter how complex, Wrabacon can provide the solution.

Wrabacon can also manufacture to customer specifications. We routinely fabricate in stainless steel, extruded aluminum and painted steel. We also manufacture to the stringent requirements of the food and pharmaceutical industries. Every piece of equipment is fully assembled and thoroughly tested before it's shipped. Wrabacon guarantees that every system will perform as specified.

Wrabacon was founded in 1986. Located in Northern New England, in an area that nurtures craftsmanship, innovation and ingenuity, our people take pride in producing quality equipment. Over the years we've built a solid reputation of providing quality equipment at reasonable cost. We at Wrabacon would appreciate the opportunity to work with you on a future project.



### Automated Conveyor Systems

- Mergers and Diverters
- Pick and Place Systems
- Lidding

### Stainless Steel Conveyors

- Vertical Accumulation
- Case Packers
- Dorner Conveyors

### Incline Conveyors

- Bi - Flow Accumulators
- Tray Stackers
- Machine Vision Systems

### Table Top Conveyors

- Rotary Tables
- Tray Denesters



## Lumsden Flexx Flow:

Single plane metal processing conveyor belts & sprockets

Flexx Flow Belting is ideal for breading, battering, cooking, coating, or almost any application from freezing to 500 degrees Fahrenheit. It has a range of uses in processing meat, poultry, seafood, baked goods.

Flexx Flow Belting is lightweight, easy to handle, and quick to install.

The Flexx Flow Belt is sprocket driven to provide positive drive and consistent tracking.

Flexx Flow Belting is designed to articulate around small diameter transfer rollers to ensure gentle handling and smooth transfer of various products.

Flexx Flow Belting is U.S.D.A. approved. Made from high tensile 302 stainless steel wire and is easy to clean.

The flow through design allows unrestricted wash down and inspection.

Flexx Flow Belting is available in the following meshes:

| SPECIFICATION  | OPENING         | WIRE DIA.     | STRAND/FOOT |
|----------------|-----------------|---------------|-------------|
| 1/8" X .035    | .135 (4.6mm)    | .035 (0.90mm) | 72.00       |
| 1/8" X .050    | .125" (4.30mm)  | .050"(1.25mm) | 72.00       |
| 6.0mm X 1.25mm | .185" (4.7mm)   | .050"(1.25mm) | 50.83       |
| 1/4" X .035    | .135 (4.6mm)    | .035 (0.90mm) | 54.00       |
| 1/4" X .050    | .200" (5.08mm)  | .050"(1.25mm) | 48.00       |
| 3/8" X .050    | .236" (6.00mm)  | .050"(1.25mm) | 42.00       |
| 3/8" X .062    | .227" (5.77mm)  | .062"(1.57mm) | 42.00       |
| 9.0mm X 1.57mm | .292" (7.42mm)  | .062"(1.57mm) | 33.88       |
| 9.0mm X 1.83mm | .280" (7.13mm)  | .062"(1.57mm) | 33.88       |
| 3/8" X .082    | .293" (7.44mm)  | .082"(2.08mm) | 32.00       |
| 12mm x 1.80mm  | .402" (10.20mm) | .072"(1.80mm) | 25.40       |
| 1/2" X .072    | .428" (10.87mm) | .072"(1.80mm) | 24.00       |
| 1/2" X .092    | .408" (10.37mm) | .092"(2.35mm) | 24.00       |
| 5/8" X .120    | .505" (12.9mm)  | .120 (3.06mm) | 19.00       |
| 3/4" X .092    | .611 (15.514)   | .092 (2.35mm) | 15.00       |

Now available with the **Edgewise Edge** to prevent tangling and reduce sharp edges

CONVEYOR BELTS

## Lumsden Flexx Flow:

Single plane metal processing conveyor belts & sprockets

### Typical processes include:

Breading, battering, forming,  
frying, cooking, coating, & baking of food products

### Most Common Specifications Used in Further Processing:

- 1/8" X .050
- 1/2" X .072
- 3/8" X .050
- 1/2" X .092
- 3/8" X .062
- 3/8" X .082
- 5/8" X .120

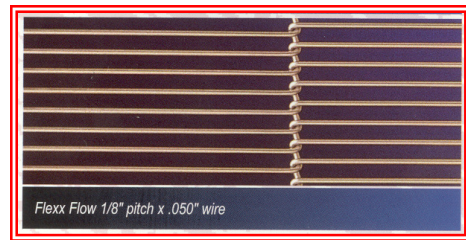
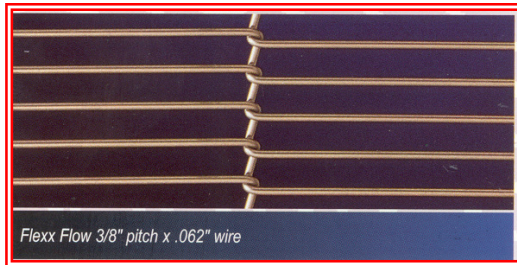

### Edgewise Belt

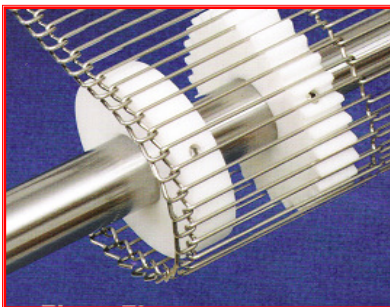

### Fixed Turn Belts 34", 42" and others

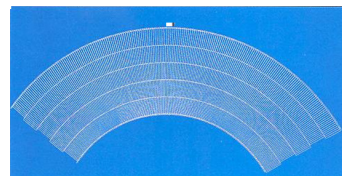

- Longer Edges** - closes the opening to dramatically reduce belt snagging
- Bend down Edges** - allows for a closed edge without restricting flexibility
- Bent in edges** - Safety Feature! Keeps sharp wire burrs from protruding out the edge of the belt
- Smallest reverse bend** - design allows for the smallest reverse bend available
- Easy to Splice** - easy as our standard belt to splice and repair
- Economical** - same price as our already low cost standard belt

Patent Pending



**Flexx Flow Features:**

- Belt widths 4 inches to 12 feet wide
- U.S.D.A. Approved
- Stainless Steel & Music Wire
- Compound Belts (Flighted for Inclines)
- Teflon Coated (Ease of Release) (Optional)

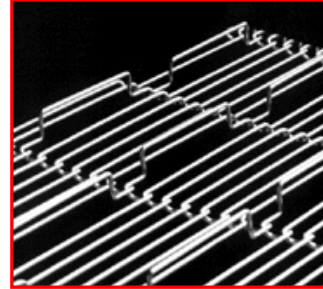

**Why Flexx Flow Style Belting?**

- Open Area - up to 85% open area, most open area in the industry
- Cleanliness - U.S.D.A. Approved, easy to clean, high grade stainless
- Positive Drive - sprocket driven
- 1.25" to 4.12" diameter, stainless steel or Delrin available
- Minimal Contact - open area provides little contact with belt
- Tight Transfers
- transfer diameters as small as 5/8" allow small products to transfer easily
- Tight Reverse Bend
- as small as 1.5" reverse bend on center drive conveyors

**Accessories available:**

- Sprockets - stainless & Delrin material
- 1.25" to 4.125" diameters metric & SAE bore sizes available

**Discharge Rollers**

- .75" to 1.25" grooved Delrin rollers 3/16" to 1" bore, metric sizes available

**Splice Clips**

- one, three, & five space clips available

**Have a belt number?**

- We follow industry standard belt numbers.
- Contact us at (704) 365-6408 for replacement belts!

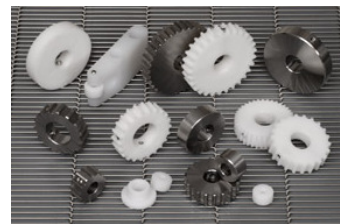

*For samples, a quote, a no charge belt survey or a review of a problem line, call us today!*

**CONVEYOR BELTS**

WIREMATION INDUSTRIES

Wiremation:



Woven Wire Metal Processing Belts  
Balanced Weave, Baking Bands, Oven Belts, Fryer Belts, Filter Belts Furnace Curtains

# Wiremation Industries

And  **BS&k Company**  
MANUFACTURERS REPRESENTATIVE

## Balanced Weave Belting

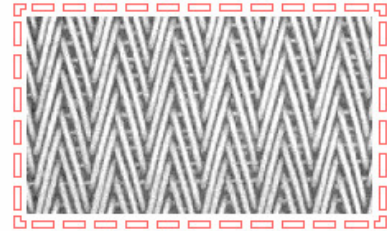
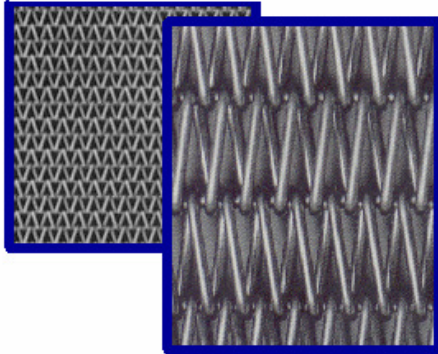

Baking Bands

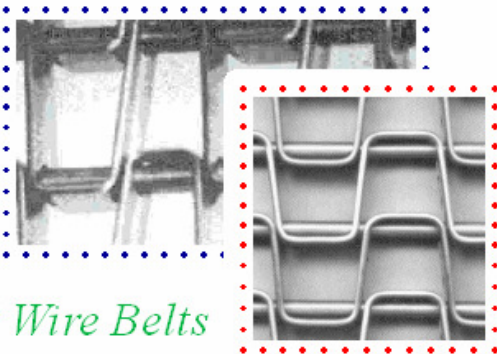

Flat Wire Belts

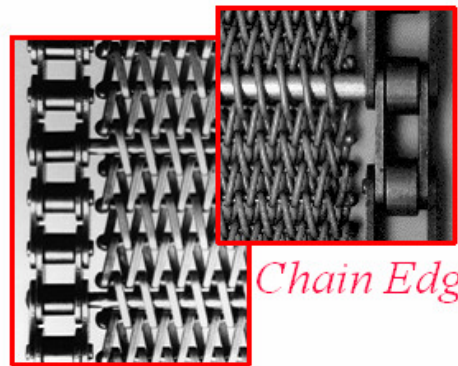

Chain Edge

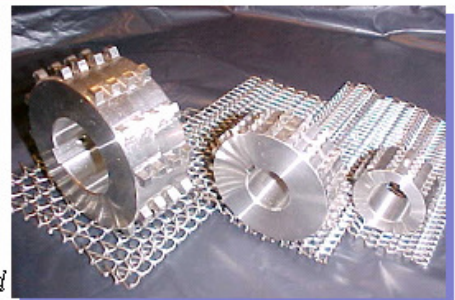

Sprocket Driven Mesh

*For All of your belting needs . . . We offer the right combination of product knowledge, applications and quality products to keep you doing what you do best . . . run your business.*

 **BS&k Company**  
MANUFACTURERS REPRESENTATIVE

*For a quick, no hasssle inquiry, or to arrange for an appointment, call us, fax us, or visit us on the web at:*  
<http://www.bsandk.com>

(800) 634-1114 (704) 365-3578 (fax)



## Wiremation:

Woven Wire Metal Processing Belts  
Balanced Weave, Baking Bands, Oven Belts, Fryer Belts, Filter Belts Furnace Curtains

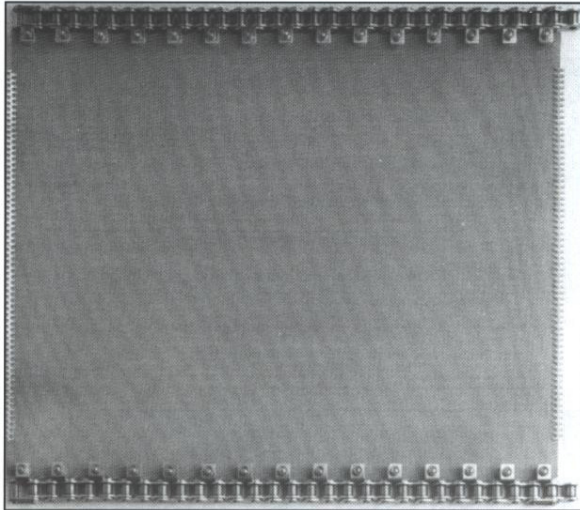

Wiremation Filter Belts are used inside fryers to catch any particles or impurities that may be collecting in the oil. These filters will extend the life of your oil as well as minimize the formation of fatty acids.

We carry all standard sizes as stock items to ensure the shortest lead times. Our manufacturing process can also handle any custom widths or lengths you may need. Wiremation Filter Belts are the same design, dimensions and quality as your original equipment manufacturer.

### SIZES AVAILABLE

|           |       |                  |
|-----------|-------|------------------|
| 80 Micron | 25"   | Wide X 163" Long |
| 80 Micron | 37.5" | Wide X 163" Long |
| 60 Micron | 25"   | Wide X 163" Long |
| 60 Micron | 37.5" | Wide X 163" Long |

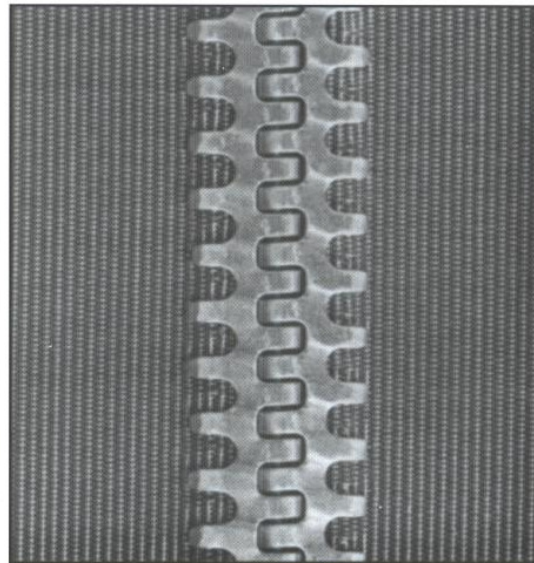

### Features & Benefits

- All our filter belts receive the "white glove" treatment and are wrapped in paper to keep any hand oils or contaminants off the mesh.
- Constructed with slug-less rivets so no slugs can fall out and damage the fryer in operation.
- We use Reverse Plain Dutch weave on all our filters for the tightest 80 and 60 micron openings possible.
- Low profile Alligator laces for the flattest belt to limit catching on the scraper blade

**WIREMATION INDUSTRIES**

**Wiremation:**

Woven Wire Metal Processing Belts

Balanced Weave, Baking Bands, Oven Belts, Fryer Belts, Filter Belts Furnace Curtains

**Furnace Curtains**

Wiremation Furnace Curtains are hung at openings and discharge of furnaces to keep heat contained, or inside the furnace to separate heat zones. The curtains are woven in a tight chevron weave mesh, which is ideal for keeping the heat from escaping the furnace, while its flexibility allows unhampered movement of materials.

Our curtains are made of high strength, corrosion resistant steel wire that can withstand heat of up to 2300F (1260C). Installing Wiremation furnace curtains is one of the simplest and most effective ways to conserve energy and save you money.

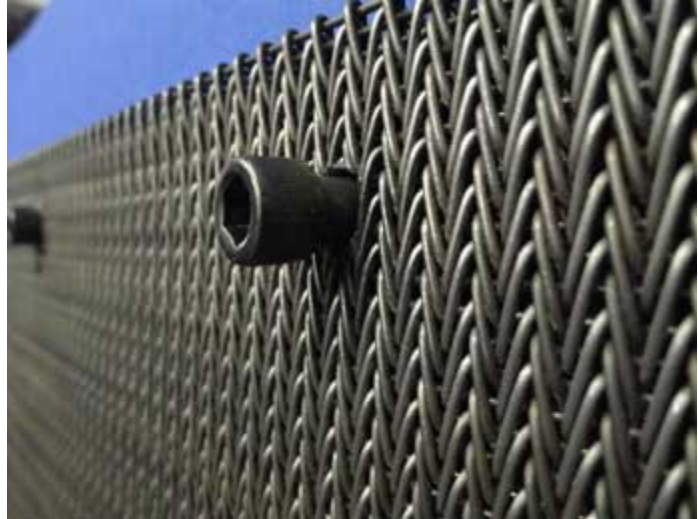
**General Specifications for Wiremation Furnace Curtains:**

| Spec # | Wire Diameter | Approx. Opening | Approx. Wt. per sq. ft. (in lbs.) |
|--------|---------------|-----------------|-----------------------------------|
| WFC-1  | .047          | 1/32            | 3.21                              |
| WFC-2  | .080-.063     | 3/64            | 4.68                              |
| WFC-3  | .080          | 1/16            | 5.76                              |
| WFC-4  | .092          | 3/32            | 6.62                              |
| WFC-5  | .105          | 3/32            | 7.86                              |

For More information or to purchase Furnace Curtains,  
 BS&k (800) 634-1114

*Special Belts:*

Fabric belts for all industries



**FDA APPROVED**  
In-Stock And Custom Cleated Food

**Strong And Versatile For ANY Food Handling Application**

*Special Belts:*

Metal Spiral Belts



Ashworth, the inventors of the low tension spiral systems, are manufacturers of turn curve belts made from metal and hybrid metal and plastic. We can design, inspect, repair, retrofit, rebuild and install a belt for you.

Let the experts work on your spiral. You will see the difference from the beginning through the work and installation. Call today and let us show you how we can help you with the latest designs, applications and products.

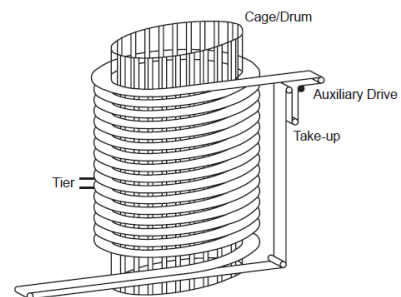

**CONVEYORS**

Conveyor Components, Wood Bearings, Plastic Bearings, Chain Guides, Guide Rails and extruded profiles

# FRICITION PROBLEMS?

## POBCO Products

- Plastic Guide Rails
- Plastic, Stainless Steel brackets
- Plastic Chain Guides & Wear Strips
- Rollers (Plastic, Steel & Wood) Bearings (Plastic & Wood)
- Plastic Sheet Stock
- Plastic & Wood Rod Stock
- FEP Shrink Fit Roll Covers
- Special Rollers
- Teflon Coated Fabric/Tapes/Belts
- Pressure Sensitive Plastic Adhesive Wear Tape



## POBCO Capabilities

- Extruding
- Molding
- CNC Machining
- Screw Machining
- Turning
- Milling
- Touting
- Secondary Operations
- Assembly
- Custom Machined & Extruded Profiles & Shapes
- Die Cutting/Punching

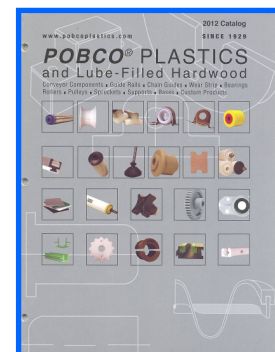

What ever friction problems you may be experiencing, we can most likely solve it with wear strips, bars, bearings or any number of other products. Don't fight it, fix it!

Conveyor Components, Wood Bearings, Plastic Bearings, Chain Guides, Guide Rails and extruded profiles

**Not Sure What Material To Use? Ask The Experts at POBCO . . .**  
*POBCO Materials*

- ULTRA-D® UHMWPE (Ultra-High Molecular Weight Polyethylene)
- Static Reduced UHMWPE
- UV Stabilized UHMWPE
- High Temperature UHMWPE
- PLUS® (Fluid Lubricant-Filled UHMWPE)
- Steel Filled UHMWPE
- Rulons® (Hi-Temp Food Grade 641, Bearing grades LR, J)
- Low & High Density Polyethylene (PE)
- Acetal (Delrin®, Celcon®)
- Delrin AF® (Teflon Filled Acetal)
- Delrin® (Also Lube-Filled & Oil Filled Types)
- DELLUBE (Solid Lubricant-Filled Delrin)
- Nylon
- NYLUBE (Fluid Lubricant-Filled High Temperature Plastic)
- Nylon MD (Lubricant-Filled Grey Nylon)(NylatronGS®)
- PVC (Polyvinyl Chloride)
- TEFLON® (High Heat Plastics) PTFE
- Teflon® Glass Filled
- POLYURETHANE (Urethane: Specify Durometer Reading & Color)
- POLYPROPYLENE
- Flurosint 207® (High Heat)
- ABS
- Polycarbonate (Lexan®, Zelux®)
- Polysulfone
- Ultem®
- High Pressure Laminate (Micarta®/Phenolics)
- Composite Bearings (High Temperature., High PV)
- Pet (Polyester)
- Torlon®
- VespeI/Sp-21®/Duron HP (polyimide)
- Peek® GF (Bearing Grade)
- Kynar® (PVDF)

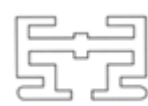

**POBCO FDA/USDA Compliant Materials**

- Ultra-D® (UHMWPE)
- Plus® (Fluid Lube-Filled UHMW)
- Acetal (Delrin® Natural & Black)
- Nylon 6/6 (101) Natural
- Nylon Cast Natural
- Teflon® Virgin Unfilled
- Rulon® 641 (High Temperature)
- Flurosint® 207 (High Temperature)
- Pet-P (Polyester Natural)
- Ultem® 1000
- Polysulfone
- Polypropylene
- High Density Polyethylene
- Stainless Steel

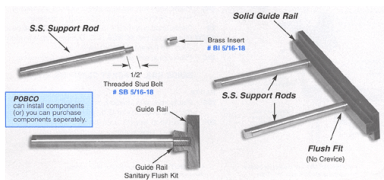
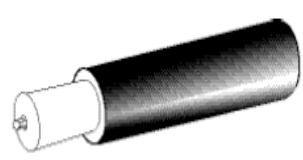

**POBCO CONVEYOR PARTS**

**Lubri-Lab:**

Oil additives and greases for increased life of bearings and engines

For many years, Lubri-Lab has been offering quality products that exceed the Highest Market Standards while keeping with leading edge technology. Concerned about the environment as well as our customer, Lubri-Lab has formulated many products necessary to resolve specific problems in the Industry.

We offer a complete line of quality greases & additives, which supply exceptional performance under all adverse conditions. (High speed, load, Impact & water wash out, and heat) Including Food Grade Products.

We will be glad to help you make a lubrication trail. We use bearing analysis that will provide you extended bearing and grease life. Helping you to be pro-active in your maintenance. We also offer oil analysis services, as well as lubrication courses, that will help your maintenance department to control costs while improving efficiency.

Lubri-Lab and the BS&k Company values highly the business you place with us and we remain committed to continuing to supply you with quality products and technical support.

**Lubri-Lab Additives include:**

**Process D** - decontaminant for engine, transmission, differential

**Xtra Diesel** - fuel conditioner, neutralizes moisture, lubricates and cleans fuel system, prevents freezing, corrosion and algies.

**Ultra G** - gear additive with an innovative formula conceived to reduce friction and noise

**Integral 7** – anti-friction formula that reduces friction, heat, wear, and helps maintain viscosity

**Multi-1**- anti-wear treatment for hydraulic systems, compressors, and turbines

**Lubri-Lab Greases include:**

**S-350** – excellent shear stability, employs passive EP characteristics, and contains no heavy metals or environmentally undesirable additives

**Top-5** – very tacky impact grease with excellent adhesion to metal, resisting water wash and high temperatures

**Poly Slick** – will maintain its lubricating properties more then twice as long as conventional soap and soap complex greases

**Alimex-1** - offers exceptional mechanical stability, high load properties, thermal stability, and resistance to water and corrosion

| Description | Range of Containers |       |          |        |         |         |  |
|-------------|---------------------|-------|----------|--------|---------|---------|--|
|             | 1qt.                | 1Gal. | 2.5 Gal. | 5 Gal. | 15 Gal. | 55 Gal. |  |
| Process D   | X                   | X     | X        | X      | X       | X       |  |
| Xtra Diesel | X                   | X     | X        | X      | X       | X       |  |
| Ultra G     | X                   | X     | X        | X      | X       | X       |  |
| Integral 7  | X                   | X     | X        | X      | X       | X       |  |
| Multi-1     | X                   | X     | X        | X      | X       | X       |  |





Quality Plastic products from REMCO.

Brushes, Shovels, Scoops, Forks, Brooms, Scrapers, squeegees, dust pans, buckets, tubs and on and on and on!

If you are looking for help on your HACCP Program, REMCO products can be color coded to prevent contaminating utensils from different areas.

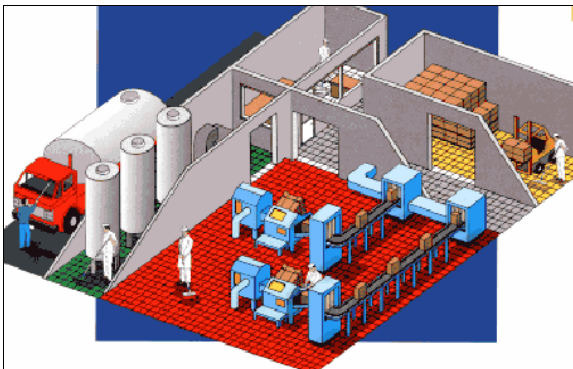

### **REMCO Products – Color Coded for Quality Assurance Protecting your customers**

One of any industry's top priorities is meeting its customers' requirements for quality. This is a challenge that can be met only with an effective, up-to-date quality assurance system that doesn't simply find errors after they occur, but that can identify potential problem areas and prevent quality lapses before they happen.

The Hazard Analysis Critical Control Point (HACCP) system was developed with this end in mind. To help ensure consistent quality, HACCP provides a thorough analysis of the production cycle and identifies specific areas of biological, chemical, or physical risk.

REMCO products are color-coded to help divide the production cycle into different zones. By identifying these zones as different cleaning areas, the movement of bacteria around the production area can be effectively blocked.

**COLORED FOR PROTECTION**

B

S

**the products you need . . .**

**the service you can depend on . . .**

BS

The BS&k Company has been a manufacturer's representative firm since 1999. We want to re-affirm our beliefs and renew our commitment that we had when we began this company.

BS&k Company was formed to fill a need that was not presently being satisfied. That is, a true liaison between the manufacturer of the product and the consumer of that product.

k

We don't claim to be, nor do we want to be, all things to all people. We have found that by placing the right product at a reasonable price in the customer's application you end up with a loyal and satisfied customer.

Ours is a long term goal. Listen, ask questions, suggest and make recommendations. Even if it means not getting the order this time. Selling a product just for a sale is not the answer. In-depth product and application knowledge, honesty, accuracy, responsibility, commitment, flexibility and a genuine concern for the customer's best interest is our business.

The manufacturer benefits by having a long term, satisfied customer base with repeat sales.

Our goal is to provide the customer a comprehensive product offering, at a fair value, with follow-up service and assistance before and after the sale. Anything else would provide little more than the competition presently provides.

Give us a try, see if you agree. We aren't the biggest, but we get the job done, because we give personal service, and follow-up after the sale. We are there when YOU need us, not just when we want to be.

*A satisfied, loyal, long term customer is worth much more than any short term profit can bring.*

COOPERATIVE



## a seasoned approach . . .

Over the years, in several previous businesses, we have learned many things. The most valuable overall lesson we have learned is to listen to what the customer says. Customers don't buy something just because you are there. They buy things to solve problems. We want to, and enjoy solving problems. Our diverse background has given us the knowledge to do this.

First, five years in the power transmission field gave a valuable education in the basics of production based manufacturing plants. We learned that *"You better not be the reason why a line shuts down."* A lesson that has stayed with us.

Next, ten plus years spent in the powdered metal field advanced my "hands-on" education and began my understanding of how valuable teamwork and sharing of ideas can be. Changing the way things were made often times let the customer reduce costs enough to keep his product marketable. We learned that *"If you aren't moving ahead, you will be left behind!"*.

Three years was spent operating a business in the printing industry. It demanded long hours, creativity and perseverance. The end result was to make the customer look their best. In addition to learning all aspects of operating a business and meeting payrolls we gained a tremendous amount of respect for the "other side", **The Customer**. Our lesson here was that *"They are willing to buy what they need at a fair price, but don't risk long term gains for short term profits."*

10 years were spent in the conveyor belt business. This is where it all really came together. Salesmanship, honesty, creativity, negotiations, respect and education. We learned that *"If you exceed expectations every time, the customers will gladly come back."*

It is not easy, but the results showed it worked.

Today, there is BS&k Company. A firm that represents only quality manufacturers and matches their products to customer needs. Our only goal is to meet the expectations of the customer and the manufacturer by solving problems and creating solutions. If we make some friends along the way, then we gained an added bonus.

We are the BS&k Company. Let us show you how we can help you.

B  
S  
&  
k  
  
C  
O  
E  
P  
R  
E  
S  
E  
N  
T  
A  
T  
I  
O  
N

B  
S  
&  
k  
  
C  
O  
R  
P  
O  
R  
A  
T  
I  
O  
N



## the value you expect . . .

- The right product for your application based on years of experience.
- Competitive pricing.
- Application / Installation / Technical on site assistance
- Complete understanding of ISO9001 procedures
- The importance of quality!
- Analysis of product usage to optimize orders/inventory/pricing.
- Diversified products to supply you the total solution, with choices.
- Professional Service Levels

## contact us at any time . . .

Office: (800) 634-1114 – Toll Free

Office: (704) 365-6408 - Local

Fax: (704) 365-3578

Cell Phone: (704) 607-2965

e-mail: [bob@bsandk.com](mailto:bob@bsandk.com)

[sue@bsandk.com](mailto:sue@bsandk.com)

web site: [www.bsandk.com](http://www.bsandk.com)

For specific product information on any of these products, literature, catalogs, dimensions, weights, details, quotations, samples or a review of your applications, please contact us at anytime.

If you don't see it, just ask.

the source for your information . . .