

Components  
to Support the  
following systems:  
Screw Conveyors  
Fertilizer Spreaders  
Roller Conveyors  
Manure Spreaders  
Drag Conveyors  
Sorters  
Feed Trucks  
Augers  
Harvesters

## Conveyor Components for the Agricultural Industry

Parts made to order, please send us your specifications.

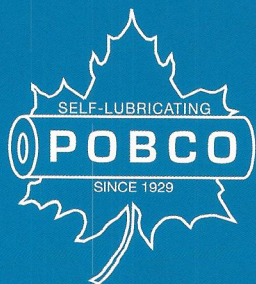

Made in the U.S.A. since 1929

[pobcoplastics.com](http://pobcoplastics.com)

# POBCO Hanger Bearings

Materials Available POBCO-B Wood Bearing Material and a variety of POBCO Plastics including POBCO UHMW, Plus (lube-Filled UHMW), Nylon\*, Nylon MD\*, PTFE, POBLON and ERTALYTE®

\*Nylon & Nylon MD (Nylatron®) DF Series Supplied with Locking Tabs (Not Pins) to prevent rotation in Hanger.

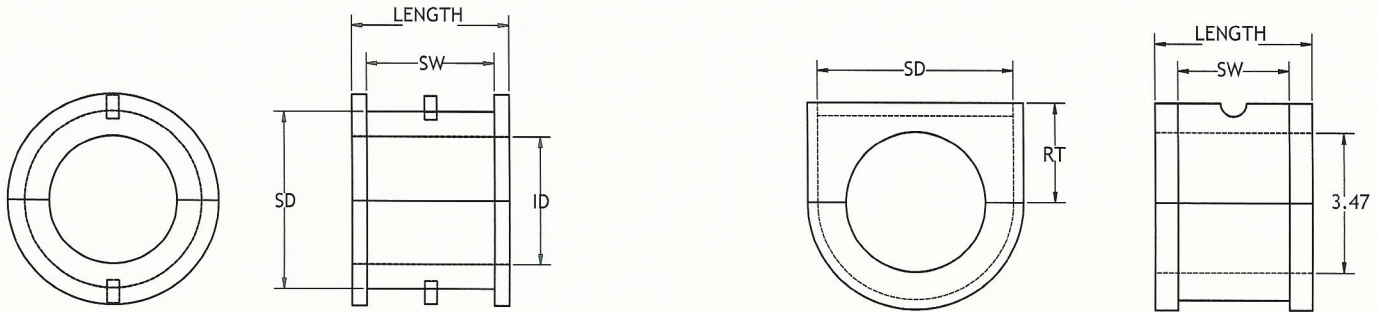

## Hanger Styles 20B, 26B, 28B, 220, 226, 326

ID	SD	SW	LENGTH	PART NO.*
1"	1-1/2"	1-1/16"	1-7/16"	DF*-162423
1-1/4"	2-1/8"	1-9/16"	1-15/16"	DF*-203431
1-1/2"	2-1/8"	1-9/16"	1-15/16"	DF*-243431
2"	2-3/4"	1-9/16"	1-15/16"	DF*-324431
2-7/16"	3-1/4"	2-3/8"	2-15/16"	DF*-395247
3"	4"	2-3/8"	2-15/16"	DF*-486447
3-7/16"	4-3/4"	3-1/8"	3-15/16"	DF*-557663
3-15/16"	5-1/4"	3-1/8"	3-15/16"	DF*-638463
4-7/16"	5-13/16"	4-1/4"	4-15/16"	DF*-719379

In general, bearing support stations on screw conveyors must be classified as severe service. The materials handled are often corrosive and abrasive and sometimes moisture laden.

Conditions are encountered that can disintegrate conventional bearings in extremely short time while also scoring and pitting the journals.

In contrast, POBCO-B Wood hanger bearings are unaffected by most corrosive materials and work well even under moist conditions. When abrasive materials are being handled, the small amount of particles that reach the bearing surface become embedded in the POBCO-B Wood material without adversely affecting the bearings' performance. These factors allow POBCO-B Wood to handle a wide variety of materials on this equipment.

## Hanger Styles 16B, 216, 216F, 230, 316

ID	SD	SW	RT	LENGTH	PART NO.*
1"	1-9/16"	1-1/8"	1"	1-7/16"	RH*-162523
1-1/2"	2-1/4"	1-3/8"	1-3/8"	1-15/16"	RH*-243631
2"	3-1/4"	1-5/8"	1-5/8"	1-15/16"	RH*-325231
2-7/16"	4"	1-5/8"	2-1/8"	2-15/16"	RH*-396447
3"	4-1/2"	2-1/8"	2-1/4"	2-15/16"	RH*-487247
3-7/16"	4-7/8"	3-1/16"	2-7/16"	3-15/16"	RH*-557863
3-15/16"	5-3/8"	3"	2-11/16"	3-15/16"	RH*-638663
4-7/16"	6-3/16"	4-1/4"	3-1/4"	4-15/16"	RH*-719979

POBCO-B Wood hanger bearings are self-lubricating for life. They are ideal for installation in screw conveyor assemblies, where the bearings are usually inaccessible. The long life of POBCO-B Wood bearings and the elimination of excessive shaft wear are major factors in reducing high maintenance costs and periodic shutdowns.

POBCO-B Wood bearings are the quietest bearings made for screw conveyors, whether operating slowly or at an accelerated pace. They eliminate the noisy metal-to-metal sounds inherent in such machinery employing metal bearings.

The hanger bearings listed are the most commonly used.

Non-cataloged hanger bearing sizes and shapes, including sizes larger than those listed, are available.

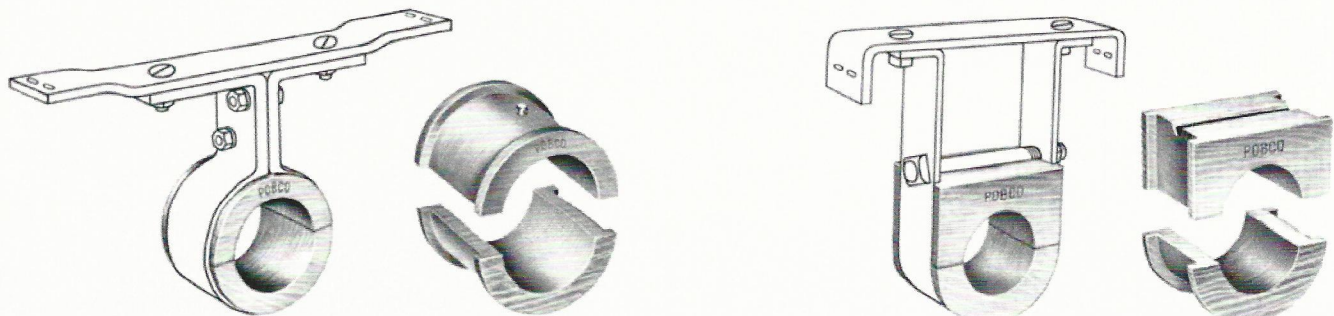

POBCO DOES NOT SUPPLY THE METAL HANGERS.

# POBCO Trimount® Pillow Blocks

Inner Spherical Bearings are available in a variety of POBCO Plastics including Ultra-D (UHMWPE), Plus (Food Grade Lube-filled UHMWPE), Nylon, Delrin® and POBCO-B Wood Bearing Material.

## Housing Materials

- Zinc Plated Steel (standard)
- 304 Stainless Steel (add "SS" to end of part #)

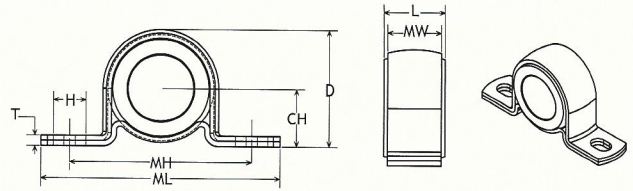

These mounting dimensions are the same as similar mounts manufactured by many major producers of anti-friction and direct journal contact bearings. ^Indicates Most Common Stainless Steel Mounts

SPHERE	CH	MH	D	ML	MW	L	H	T	SHAFT SIZE***	PART NUMBER**
2" Sphere Medium Duty Mount	1-1/16"	3-1/4"	2-1/16"	4-9/16"	1-5/16"	1-1/2"	25/64 x 5/8"	1/8"	3/4" 13/16" 7/8" 15/16" 1" 1-1/16" 1-1/8" 1-3/16" 1-1/4"	^BC*-12 ^BC*-13 ^BC*-14 ^BC*-15 ^BC*-16 ^BC*-17 ^BC*-18 ^BC*-19 ^BC*-20
2" Sphere Heavy Duty Mount	1-3/32"	3-5/16"	2-1/8"	4-5/8"	1-5/16"	1-1/2"	25/64 x 5/8"	3/16"	3/4" 13/16" 7/8" 15/16" 1" 1-1/16" 1-1/8" 1-3/16" 1-1/4"	^BF*-12 ^BF*-13 ^BF*-14 ^BF*-15 ^BF*-16 ^BF*-17 ^BF*-18 ^BF*-19 ^BF*-20
2-1/2" Sphere Medium Duty Mount	1-11/32"	3-7/8"	2-11/16"	5-3/8"	1-7/16"	1-3/4"	25/64 x 25/32"	7/32"	1" 1-1/16" 1-1/8" 1-3/16" 1-1/4" 1-5/16" 1-3/8" 1-7/16" 1-1/2" 1-9/16" 1-5/8" 1-11/16" 1-3/4"	^BK*-16 ^BK*-17 ^BK*-18 ^BK*-19 ^BK*-20 ^BK*-21 ^BK*-22 ^BK*-23 ^BK*-24 ^BK*-25 ^BK*-26 ^BK*-27 ^BK*-28
3-1/4" Sphere Heavy Duty Mount	1-3/4"	5-1/2"	3-1/2"	7-1/4"	1-3/4"	2"	21/32 x 1"	9/32"	1-1/2" 1-5/8" 1-11/16" 1-3/4" 1-15/16" 2" 2-1/8" 2-3/16" 2-1/4" 2-7/16" 2-1/2"	BL*-24 BL*-26 BL*-27 BL*-28 BL*-31 BL*-32 BL*-34 BL*-35 BL*-36 BL*-39 BL*-40  Not available in Stainless Steel.

POBCO metal mounted bearings combine POBCO-B self lubricating wood bearing inserts, or UHMW and Plus (lube filled UHMW) inserts with stamped steel housings. Housings are commonly furnished in Zinc Plated Steel or Stainless Steel.

For Pillow Block styles, the inserts can be One piece spheres, or split Two piece style.

The most common series for the agriculture industry is the BK series pillow block (2-1/2" sphere OD) with POBCO-B wood insert. Fertilizer spreaders commonly use the Split insert style so that the bearing insert can be replaced as needed, without having to slide all the way to the end of the shaft.

Replacement inserts can be purchased separately.

Circular Center Flange



Pillow Block



4-Bolt Side Flange



POBCO Locking Collars are available in metal, plastic and hardwood materials.

**MATERIALS MUST BE SPECIFIED**



2-Bolt Center Flange



Triangular Center Flange



2-Bolt Side Flange

# POBCO Custom Drag Flight Specifications

Quantity: \_\_\_\_\_ Part No: \_\_\_\_\_ Date: \_\_\_\_\_  
 (given when ordered)

Customer: \_\_\_\_\_

Phone: \_\_\_\_\_ Fax: \_\_\_\_\_

## ROUND BOTTOM FLIGHTS

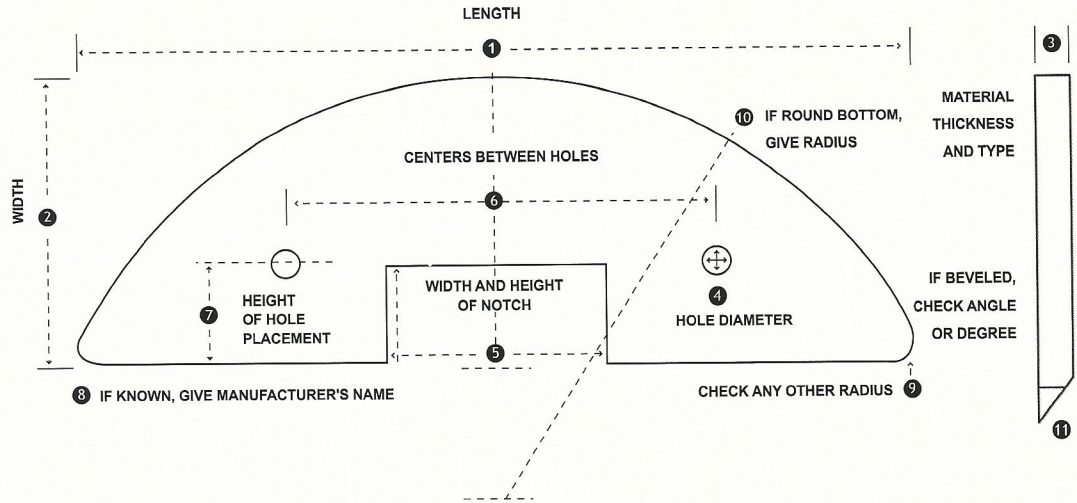
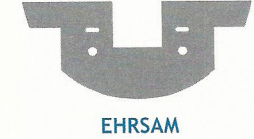
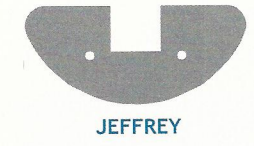
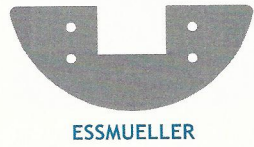

## EN MASSE FLIGHTS

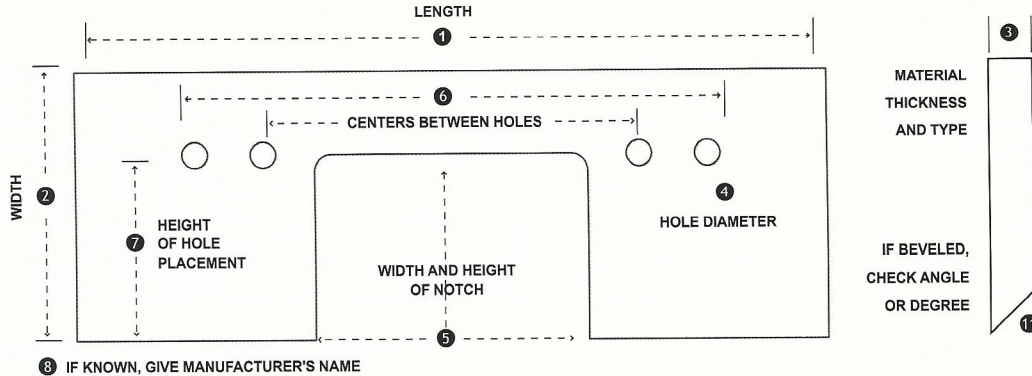

Please fill in the following information and fax back to POBCO® @ (508)791-3247

Round Bottom Flight  En Masse Flight

Material: \_\_\_\_\_ 6 \_\_\_\_\_

1 \_\_\_\_\_ 7 \_\_\_\_\_

2 \_\_\_\_\_ 8 \_\_\_\_\_

3 \_\_\_\_\_ 9 \_\_\_\_\_

4 \_\_\_\_\_ 10 \_\_\_\_\_

5 \_\_\_\_\_ 11 \_\_\_\_\_

# POBCO Screw Conveyor Flight Edging

POBCO Ultra-D Flight Edging is used to snap-on over the screw conveyor flight to extend the life of the flight and to allow for improved clean-out of the trough. It is normally installed by winding it along the screw so that it snaps on in the well between the flights and secured with metal rivets. Starting at one end the UHMW plastic is tapped into place by moving along the length of the screw. This Ultra-D plastic is stabilized against ultra-violet light radiation. The center bearing on short conveyors can sometimes be eliminated when the center of the screw sits lightly in the trough.

- UV Stabilized For Outdoor Use
- Improve Clean-Out Of Troughs
- Eliminate Hangers On Shorter Runs
- Use With Helicoid Or Sectional Flights
- Reduce Noise And Wear On Rubbing Screws

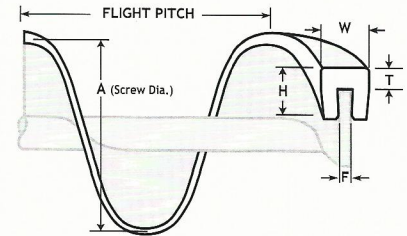

To determine approximate amount of edging required in feet when:

- Full Pitch = length of conveyor section in feet x 3.4
- Half Pitch = length of conveyor section in feet x 6.7
- Irregular Pitch = no. of pitches x Dia. (in inches) x .262

## 50 FT. STANDARD COIL LENGTHS. MANY SIZES IN STOCK.

ULTRA-D PART NUMBER	"A" DIA. OF SCREW	"F" FLIGHT THICKNESS	"W" WIDTH ACROSS TOP	"T" THICKNESS OF WEAR TOP	"H" HEIGHT
PFE4-6-063	6"	1/16"	.440"	.350"	.750"
PFE4-6-104	6"	3/32" & .104"	.440"	.340"	.870"
PFE4-6-134	6"	1/8" & .134"	.440"	.350"	.750"
PFE6-6-188	6"	3/16"	.630"	.350"	.750"
PFE7-6-375	6"	3/8"	.630"	.350"	.750"
PFE4-93/8-.09.15	9" to 9-3/8"	3/32" & .104"	.440"	.150"	.800"
PFE4-9-.09.25L	9"	3/32" & .104"	.430"	.250"	.770"
PFE4-9-104	9"	3/32"	.440"	.340"	.870"
PFE4-9-134	9"	1/8" & .134"	.440"	.350"	.750"
PFE6-9-188	9"	3/16"	.630"	.350"	.750"
PFE6-9-250	9"	7/32" & 1/4"	.630"	.350"	.750"
PFE7-9-375	9"	3/8"	.630"	.350"	.750"
PFE4-12-.09.25L	12"	3/32" & .104"	.440"	.245"	.775"
PFE4-12-104	12"	3/32"	.440"	.340"	.870"
PFE4-12-134	12"	1/8" & .134"	.440"	.350"	.750"
PFE6-12-188	12"	3/16"	.630"	.350"	.750"
PFE6-12-250	12"	1/4"	.630"	.350"	.750"
PFE7-12-375	12"	3/8"	.630"	.350"	.750"
PFE4-16-134	16"	1/8" & .134"	.440"	.350"	.750"
PFE6-16-188	16"	3/16"	.630"	.350"	.750"
PFE6-16-250	16"	7/32" & 1/4"	.630"	.350"	.750"
PFE7-16-375	16"	3/8"	.630"	.350"	.750"
PFE6-18-188	18"	3/16"	.630"	.350"	.750"
PFE6-18-250	18"	7/32" & 1/4"	.630"	.350"	.750"
PFE7-18-375	18"	3/8"	.630"	.350"	.750"
PFE6-20-188	20"	3/16"	.630"	.350"	.750"
PFE6-20-250	20"	7/32" & 1/4"	.630"	.350"	.750"
PFE7-20-375	20"	3/8"	.630"	.350"	.750"
PFE6-24-188	24"	3/16"	.630"	.350"	.750"
PFE6-24-250	24"	7/32" & 1/4"	.630"	.350"	.750"
PFE7-24-375	24"	3/8"	.630"	.350"	.750"
PFE6-30-188	30"	3/16"	.630"	.350"	.750"
PFE6-30-250	30"	7/32" & 1/4"	.630"	.350"	.750"
PFE7-30-375	30"	3/8"	.630"	.350"	.750"



Inquire also for Chain Guides, Sprockets and Wear Strips.  
Please contact your local representative at:

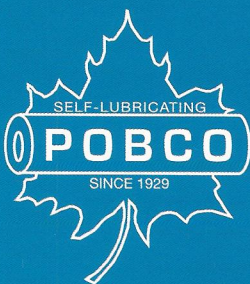

POBCO, Inc.  
99 Hope Ave | Worcester, MA 01603  
508.791.6376 | 1.800.222.6376  
pobco@pobcoplastics.com | pobcoplastics.com